

DESCRIPTION

The Camlok BulbBarSectionClamp has been designed specifically for lifting, turning and handling bulb bar sections or fabrications containing bulb bar sections up to a surface hardness of 300 Brinell. The clamp is fitted with a Camlok spring operated safety lock.

DIAGRAM

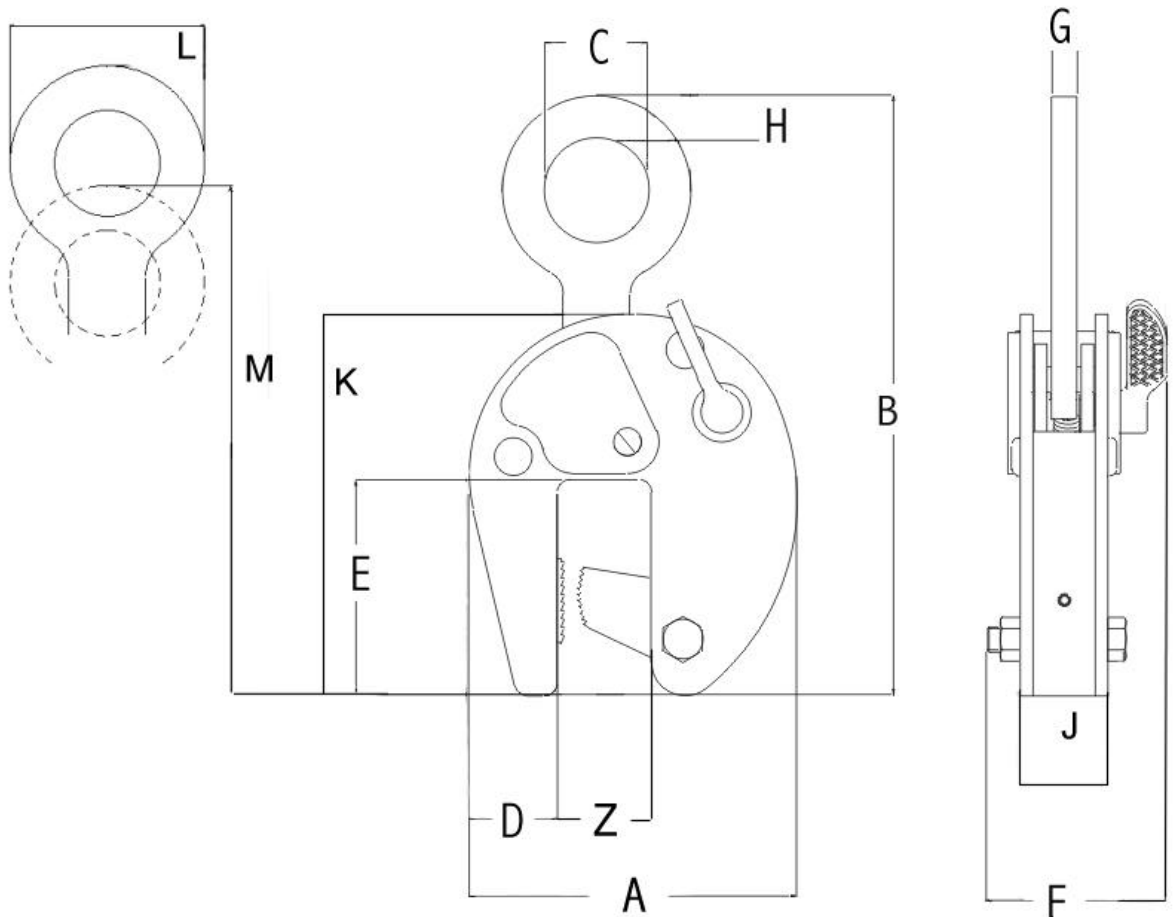

TABLE

MODEL	WLL Ton s	Bulb mm Z	Weigh t kg	A	B	C	D	E	F	G	H	J	K	L	M
CB 0,75	0,75	40	6	158	287	51	47	103	79	13	20	42	182	90	266
CB 1,5	1,5	60	12	220	374	67	55	147	108	13	21	60	258	108	343
CB 3	3,0	83	32	303	549	90	68	215	125	20	35	70	372	160	504
CB 4	4,0	83	42	310	510	90	120	165	125	20	35	70	325	160	445
CB 6	6,0	83	44	358	564	90	120	215	125	25	41	70	391	172	522
CB 8	8,0	83	50	360	641	130	125	190	135	25	55	80	415	240	573
CB 10	10,0	83	57	360	641	130	125	190	148	30	55	90	415	240	573

Load Diagram with sling vertical

Loads weighing the maximum W.L. may be lifted through 15 degrees in the plane of the clamp

Loads weighing the maximum W.L. may be lifted and turned through 180 degrees in the plane of the clamp

Load must hang no more than 15 degrees when suspended by the clamp only.

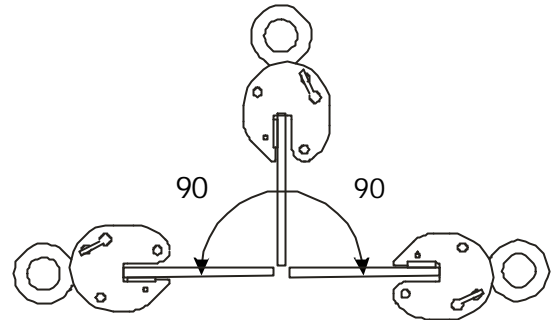
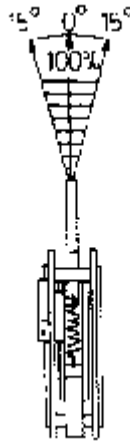
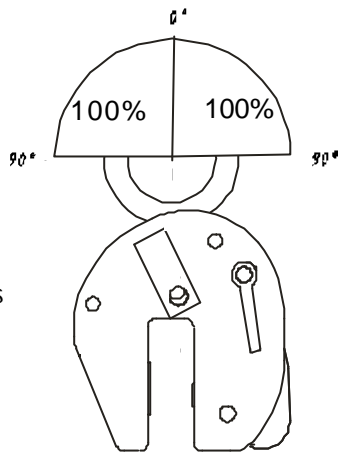

RESTRICTIONS

The working load limit of the clamp should be as close as possible to the actual load to be lifted. This ensures that the clamp is working at maximum efficiency. Loads below 20% of the working load limit should be avoided extra care must be taken when lifting plates in the lower 20% of the rated jaw capacity. Excessive wear and a reduction in working life can be caused if a clamp is continuously used to lift the same thickness material.

FOR SHORT LENGTHS

A single clamp can be used

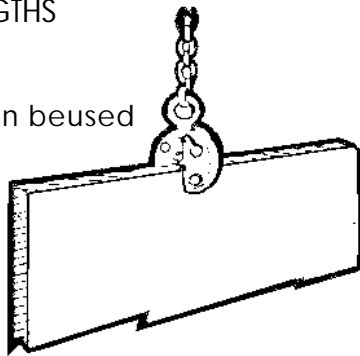

FOR LONG LENGTHS

2 clamps and a lifting beam must be used

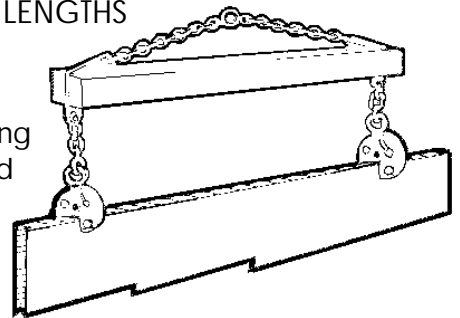

OPTIONS

The clamp is supplied as standard with a hook ring this can however be replaced with an integral short chain sling for direct connection to a larger hooked lifting appliance.

